

- General Notes**
1. Do not scale
 2. All dimensions are shown in millimetres unless otherwise noted
 3. Refer to project based risk assessments before undertaking any work
 4. Notify the architect of any discrepancy immediately

Specification & Performance Notes

Refer to S/E design for steelwork, structural timber, lintels, foundations and slab design.

New External (Brickwork) Walls
 U-Value 0.18 W/m²K or better.
 92.5mm insulated plasterboard, (EcoLiner) + Skim
 215mm brick wall, or 100mm facing brick with 100mm blockwork internal leaf.
 Facing brick to be of london stock to match existing.
 Refer to S/E spec for block strength, joints, ties etc.

New Internal Floor
 30min fire separation
 min 40dB sound reduction.
 15mm 10kg/m² dense plasterboard, tape, fill & skim
 100mm mineral flexi batt between joists
 18mm T&G flooring grade chipboard over,
 glued and screwed to receive finishes.

Windows & Doors
 Windows to achieve U-Value of 1.2W/m²K
 Glazed Doors to achieve U-Value of 1.2W/m²K
 Opaque Doors to achieve U-Value of 1.0W/m²K
 Weather tight seals between frame and wall
 Cavity closers to perimeter
 Trickle vents to all.

Internal Partitions
 Achieve min 30min fire resistance
 15mm 10kg/m² dense plasterboard, tape, fill & skim to each side of:
 100mm timber studs to S/E spec
 Mineral or Glass quilt to cavity
 12mm ply pattressing between studs where required.
 Moisture resistant to bathrooms, wc and kitchen.

New Internal Doors
 FD 30 Doors frames and ironmongery to all new doors at second floor level.

Replacement of Internal Doors Ground & First Floor
 Replace internal doors connecting rooms to stair / hall at ground and first floors to become FD30 rated, with new ironmongery to suit.

SD Mains powered & interlinked Smoke Detector & sounder

HD Mains powered & interlinked Heat Detector & sounder

Part B- Fire Safety Notes
 Internal partitions and floors 30min fire resisting
 Party wall 60min fire resisting.
 Heat detector in kitchen
 Smoke detector in ground floor hall
 Smoke detector in first and second floor landing
 All windows to be fire egress windows

Part F- Ventilation Notes
 WC to have mechanical extract linked to light switch providing 6l/second with 15min override
 Kitchen to have mechanical extract over cooker providing 30l/second
 Bathroom to have mechanical extract with 15l/second with 15min override

Pitched Roof & Mansard Construction (From Inside)
 0.18W/m²K U Value or better
 37.5mm EcoLiner under joists (Integral VCL)
 150mm Ecotherm Ecoveral between rafters
 Tyvek vapour open membrane over rafters
 25x50mm treated counterbattens over rafter.
 25x50mm treated tiling battens
 Artificial slate tiles to match existing.

Flat Roof Construction (From Inside)
 0.18W/m²K U Value or better
 15mm 10kg/m² dense plasterboard, tape, fill & skim
 Timber joists as S/E design
 Fittings set to 1:40 fall fixed to joists
 25mm WBP Ply deck glued & screwed over furring.
 Rigid insulation to achieve u-value described.
 15mm WBP Ply deck fixed over insulation
 Warranted weatherproof membrane over-
 Single ply membrane, built up felt, resin or EPDM.

Water Use 125l/person/day
 Target Usage, (Not all fittings used)
 Low volume dual flush WC 4/6L
 WC 6/4 litres dual flush or 4.5 litres single flush
 Shower 10 l/min
 Bath 185 litres
 Basin taps 6 l/min
 Sink taps 8 l/min
 Dishwasher 1.25 l/place setting
 Washing machine 8.17 l/kilogram

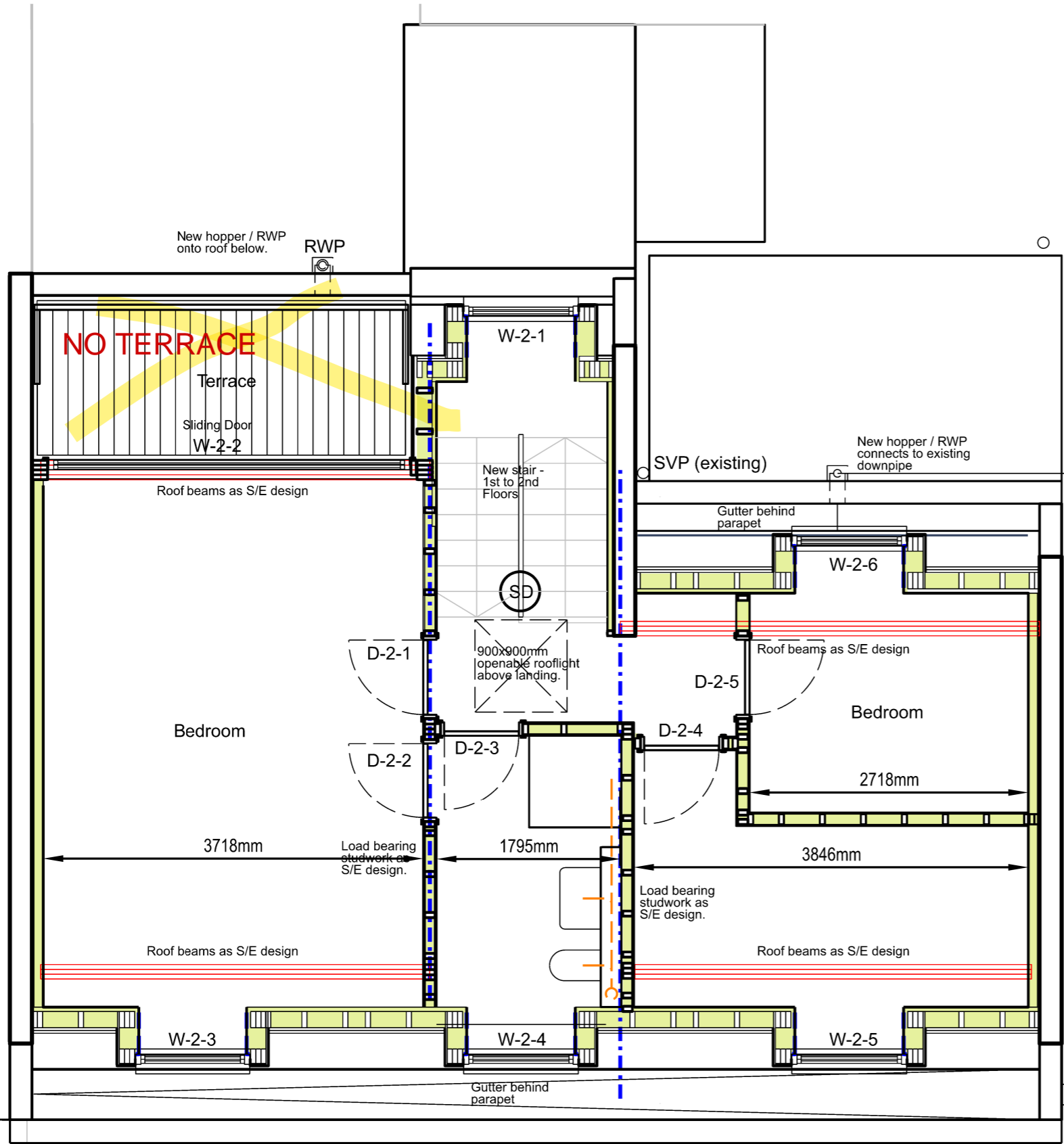

New RWP
 Contractor to identify appropriate route to connect to mains drain.

Contractor to identify suitable route for new SVP and waste drainage from new second floor shower / basin / WC.

0m 0.5m 1m 1.5m 2m 2.5m

Proposed Second Floor

Revision P3	Scale @ ISO A3 1:50	Approved By DL
Drawing Number A-2-003		