

## DISARMING THE SYSTEM WHEN ON THE PREMISES

1. Go to the panel via the designated route.
2. Press RESET.
3. Enter user code. The unit will enter the DAY mode and the yellow DAY light will illuminate.

N.B. If an incorrect user code is entered 4 times the panel will go into alarm and the 24 HOUR LED will light to indicate the unit has been tampered with.

## NIGHT TIME SECURITY - ARMING THE SYSTEM WHEN ON THE PREMISES

1. Check DAY light on.
2. Enter user code. DAY light extinguishes.
3. To omit zones not required, press ZONE OMIT (DAY LED starts flashing).
4. Enter the number(s) of the zone(s) not required. The selected zone lights will be illuminated.
5. Press ARM and the exit tone will be heard. It is possible to QUICK SET the system and silence the exit Tone by pressing the QUICK SET button (provided no sensing devices have to be passed).
6. Note - The last select zone omitted will be stored in the memory. Subsequent Night Time arming only requires zone omit button to be pressed to recall stored zone(s).

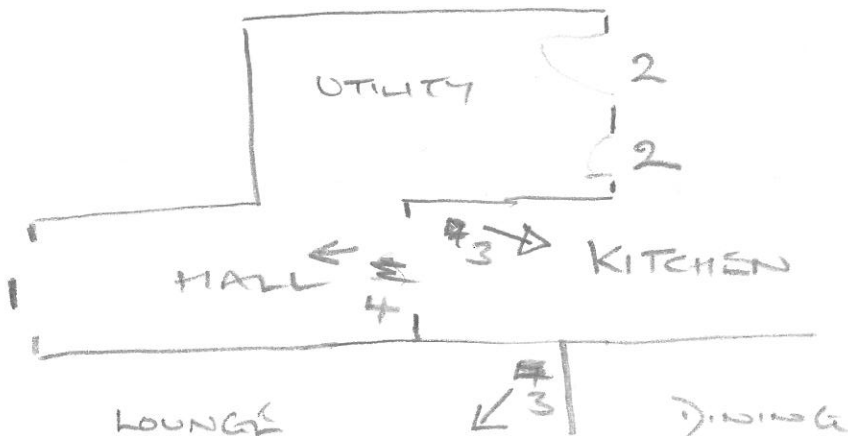

## 4 ZONE PROFESSIONAL ALARM SYSTEM

## INSTALLATION INSTRUCTION BOOK

The Security System you have purchased consists of the following items:-

- 4 Zone Microprocessor based Control Panel
- Bell Box
- Siren
- Rechargeable Self-actuating Siren Module (RSCB)
- 2 x Passive Infra Red Detectors (PIRs)
- 2 Pairs of Magnetic Contacts (M.C.)
- 12 Volt Rechargeable Battery
- 50 Metres of 6 Core Cable
- Cable Clips and Fixings
- Spare Control Panel Fuses

## INTRODUCTION

**PLEASE READ THE FOLLOWING INSTRUCTIONS CAREFULLY  
TO ENSURE A PROBLEM FREE INSTALLATION**

## PLANNING THE INSTALLATION

The plan below shows an example of a typical installation of the items contained in this system however additional detection devices can be purchased to expand the system to suit any requirements.

Fig. 1.

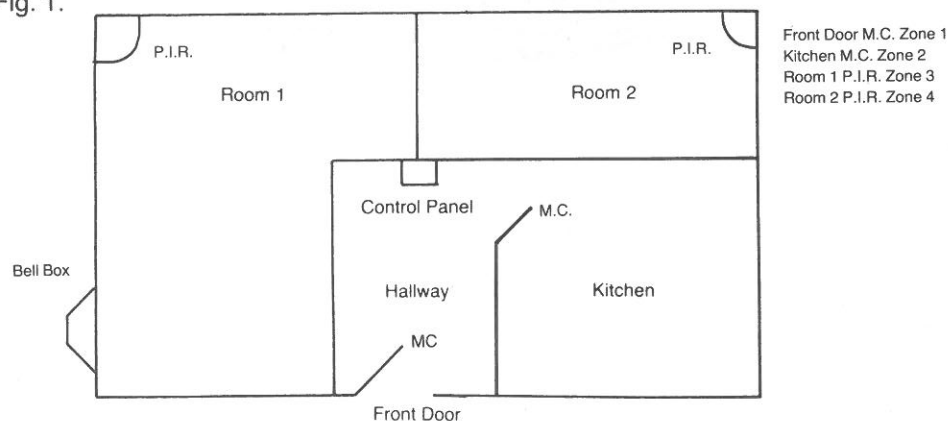

We strongly recommend that you prepare a rough diagram of the property and mark where best to site the detectors, bearing in mind the concealment of cables and ease of fixing of detectors.

It is worth careful consideration if a pet is in the household, as PIRs ought not to guard areas in which the pet is allowed free access whilst the alarm is set.

## INSTALLATION

### FITTING THE CONTROL PANEL

Site the panel in a position (above the accessible height of small children, or in a cupboard, close to a mains electricity supply).

It is NOT advisable to wire the control into either a lighting circuit, or a ring main into which appliances with electric motors are plugged, eg. refrigerators, vacuum cleaners, etc. The reason for this is that motors generate mains surges which can cause the microprocessor to momentarily malfunction.

The ideal mains supply is direct from the consumer unit, on its own fused spur.

1. Remove the 2 screws on the front cover, and place safely to one side in the polythene bag provided to eliminate the chance of damage.
2. Mark the 2 screw holes on the left and right hand sides of the top and the hole in the bottom centre on the wall and fix the panel accordingly.
3. The unit should be mounted on an even surface to prevent distortion. Remove the thin wall section of the base where the cables are required to enter.

### SECURITY CODES

To programme the control panel either the user code (factory set 1234) or engineer code (factory set 9999) will be used. It is practical to leave the factory codes unchanged until the installation is complete.

### TESTING THE UNIT

The panel is fitted with factory fitted links, to enable the panel to be tested prior to installation. (The tamper microswitch spring will need to be hooked under the bridge to depress the microswitch, otherwise a 24 hour fault will show and the sounder will be activated).

1. Fit the 12 volt battery to the unit, observing the correct polarity and the alarm will sound, enter factory code (1234) PA, LED will illuminate, press reset. This sequence should be repeated whenever the power is interrupted.
2. Enter the factory user code - 1234, and the LED will be extinguished.
3. Remove a factory fitted link and the respective zone LED will light and a 2 tone indication will be heard. Refit the link and the zone LED will extinguish.
4. Repeat steps 2 and 3 for all other zones.
5. Test the lid tamper by repeating steps 2 and 3 and releasing the lid tamper spring.
6. Replace the spring under the bridge to hold down the tamper.

### DETECTOR PLAN

Before fitting the detectors, plan which detector groups are to be connected to which zones. Note one zone has to be allocated to entry/exit. Zone 1 is factory set

as entry/exit. It is advisable to keep a note of detectors/zones to assist with fault finding or future extensions to the system.

## CONNECTION OF DETECTORS TO THE PANEL

### N.B. ALWAYS USE THE CORRECT POLARITY

The detectors can be classified into 2 categories:-

**NORMALLY OPEN** ie. Pressure mats which are devices that upon activation make a closed circuit.

**NORMALLY CLOSED** ie. PIRs and magnetic contacts. Upon activation the circuit becomes open, ie. the current through them stops flowing.

### FITTING OF THE DETECTORS

1. Connect the battery
2. Enter the user code (1234)
3. Remove the wire link from the required zone. The zone light will be illuminated and the control will beep.
4. Connect the detector pair of wires into the zone and the LED will be extinguished, and the beeping will cease. If it does not there is a fault in either the wiring or the detector. To ascertain in which area the fault lies disconnect the detector and twist the detector pair together. If the LED extinguishes then the fault is in the detector, if not, it is in the wiring.
5. Next connect the power wires into the AUX terminals - observing correct polarity.
6. Connect the tamper circuit wires into the 24 HOUR terminals.
7. If normally open devices are fitted, connect one side to the zone and the other to the 24 hour terminal.

### FITTING PA PUSHES (not supplied)

PA buttons can be fitted to the system as follows:-

Fig. 2.

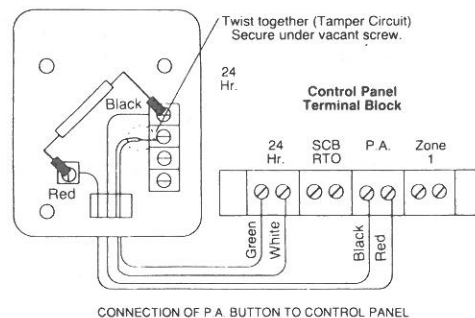

The PA pushes can be sited near the front door, or in a bedroom.

It is advisable to site them out of the reach of small children, and with the keys in a safe place.

If more than one P.A. Push is fitted, they should be wired in series, see Fig. 7.

### FITTING THE MAGNETIC CONTACTS

1. Screw the magnet half to the door as close to the edge as possible on the opposite side to the hinge.
2. Wire the reed half of the contact, as shown below, and wire back into the required zone in the panel. See Fig. 4.

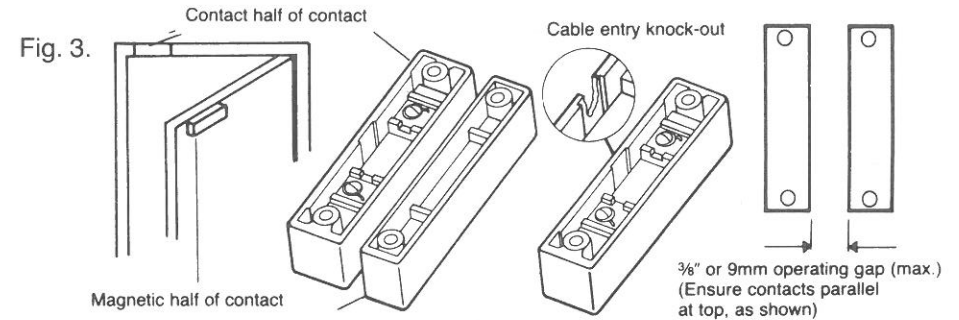

3. It is advisable to use a contact for the final entry/exit door, and so wire into this zone.
4. Up to 10 magnetic contacts can be fitted to the same zone. If more than one contact to a zone wire as follows:-

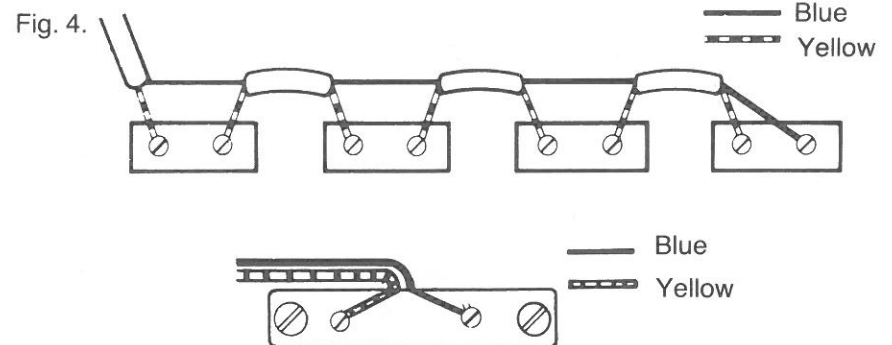

If magnetic contacts and P.I.R.s are wired to the same zone they must be connected in series and not in parallel. The power supply of the P.I.R.s should continue to be wired in parallel, see Fig. 7.

Fig. 11.

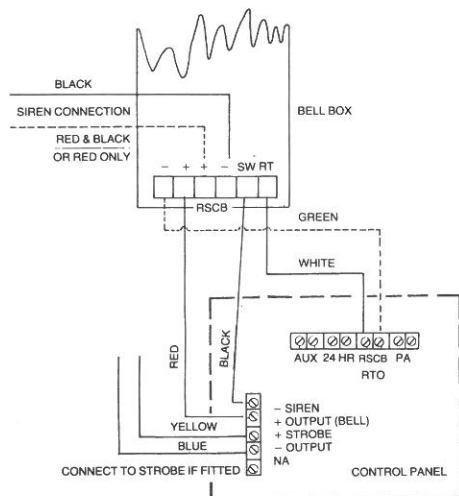

7. It is possible to fit a strobe light (an optional extra) to the bell box. This is particularly useful to indicate the system has been in alarm when returning to the property after the system has timed out after 20 minutes and reset.
8. Replace the front of the bell box. Tighten the retaining screw in the cover until switch, then one more turn. The unit is now tamper proof.

### TESTING THE SYSTEM

1. Press PROG FUNC. All LEDs will illuminate.
2. Insert user code (1234). The DAY light will now flash.
3. Press 3. The DAY LED will illuminate.
4. Press 2. The strobe (if fitted) will be activated. Press 2 to deactivate.
5. Press 1. The siren will sound. Press 1 to deactivate.
6. Press reset. The LED will now flash.
7. Press reset again to exit programme function.

### CONNECTION TO THE MAINS ELECTRICITY SUPPLY

When all connections are complete, connect the mains electricity supply.

IF IN ANY DOUBT AS TO HOW TO MAKE THE CONNECTIONS CONSULT A QUALIFIED ELECTRICIAN.

Connect as follows:-

Live (L) Red/Brown Neutral (N) Black/Blue Earth (E) Green and Yellow to the panel via an unswitched fused spur.

Remove the anti-tamper spring from under the edge of the bridge and replace the cover of the control panel.

## USER OPERATING INSTRUCTIONS

### ARMING THE SYSTEM

1. Press RESET
2. Insert user code. DAY light will extinguish.
3. Check all zone lights extinguished. If light on check detectors on that zone, ie. open door.
4. Once all zones cleared, press ARM.
5. Leave promptly via the exit route whilst the exit sound is heard.
6. Once the exit sound has stopped the system will be armed.

### DISARMING THE SYSTEM

1. Enter via the Entry/Exit route.
2. The entry tone will be heard.
3. Press RESET.
4. Enter the user code.
5. The DAY LED will illuminate.
6. If the alarm has activated in your absence the zone(s) activated will be shown.

### EVENT REPLAY

If the system has been activated the EVENT REPLAY feature will enable you to discover which zone(s) the intrusion took place in.

1. Do not press RESET after alarm has been switched off.
2. Press EVENT REPLAY up to 4 times to display past events.
3. Press RESET twice to return to the DAY mode.

## FITTING THE PASSIVE INFRA RED DETECTOR

1. Fit the PIR on any flat surface in the top corner of a room, in a position to deter intruders.
2. **DO NOT** Site the PIR over a heat source.  
Site the unit looking directly at a window.  
Run the alarm cable near to mains cables.
3. Remove the cover by gently pulling the front cover from the base. Remove the 2 fixing screws holding the printed circuit board (PCB) from the base.

Screw the base onto the wall using the screws and plugs provided.

Pass the end of a length of 6 core cable through one of the holes in the base.

Refit the PCB, with the terminal block to the bottom.

Connect the cover with the circular pattern to the base.

Wire as follows:-

PIR + to Panel AUX + Red  
 PIR - to Panel AUX - Black  
 PIR N to required zone terminal Yellow  
 PIR C to the other terminal required zone Blue  
 PIR 24 terminals to the 24 hour terminals in panel Green & White

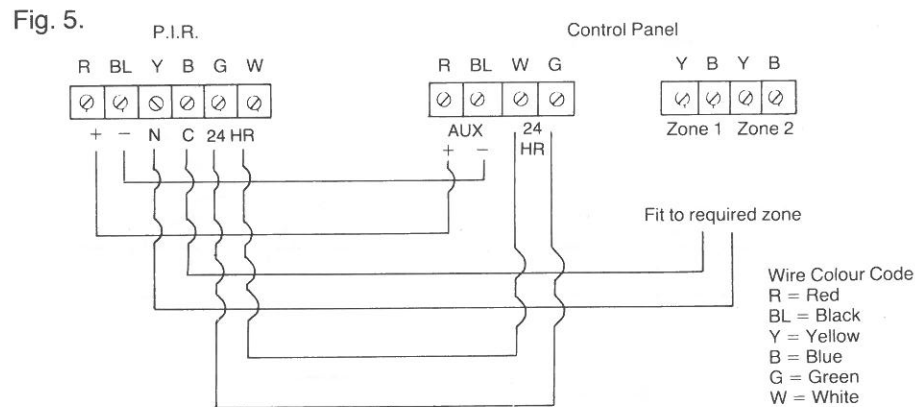

If P.I.R.s and magnetic contacts are wired to the same zone they must be connected in series and not in parallel. The power supply should continue to be wired in parallel, see Fig. 7.

## 4. Adjustment (Range)

There is a vertical adjustment of the pcb to give the required range. Move pcb up to increase, and down to decrease.

## 5. Walk Test

After the system is powered up, allow 4 minutes for the PIR to stabilise. Slowly walk across the field of view and as you enter and exit a detection zone the LED will illuminate. Allow 10 seconds between each test to allow the unit to restabilise.

6. After a period of time, the LED is designed to become quiescent, if it is required to continue flashing, switch off the power and then power it up again.

Fig. 6.

## PLAN VIEW OF DETECTION PATTERN

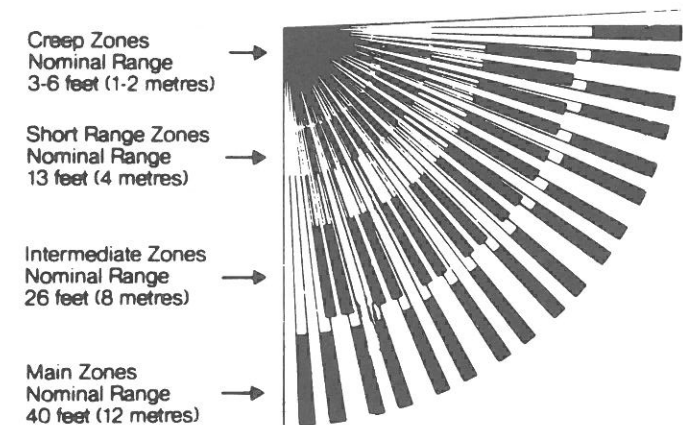

## SIDE VIEW OF DETECTION PATTERN

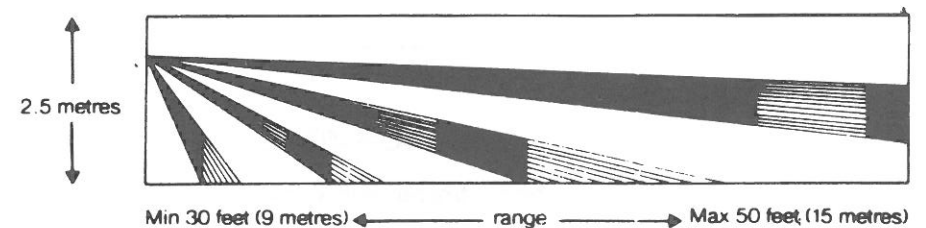

## WIRING EXAMPLE

Fig. 7.

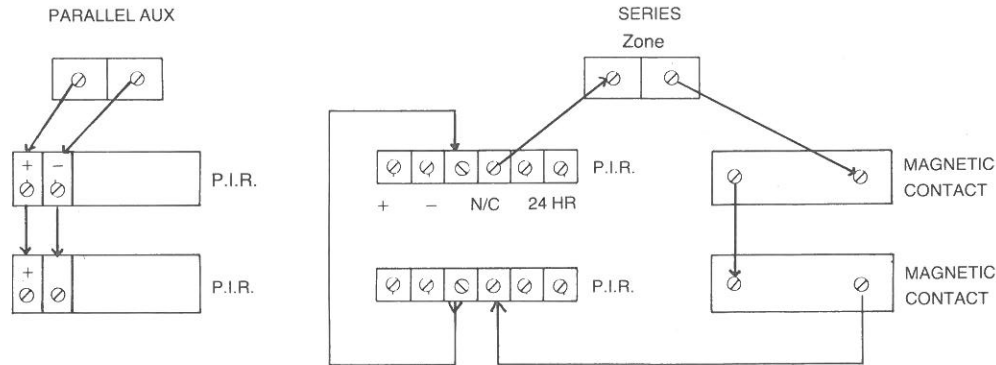

## ENTRY/EXIT

The main entry/exit route into the premises should be selected as the Entry/Exit zone. This is normally the front door of the property. Use of this facility allows a predetermined time to access the building via this route to disarm the control panel. Entry by any other route will result in an instant alarm.

Fig. 8

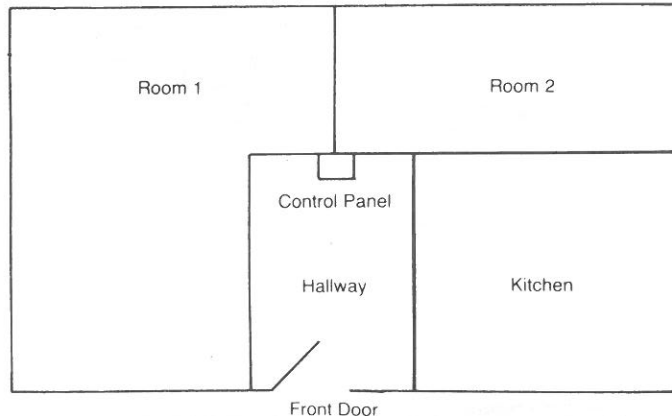

## WALK THROUGH ZONE

It is sometimes desirable to site the control panel in a position which is guarded by an additional detector.

Fig. 9.

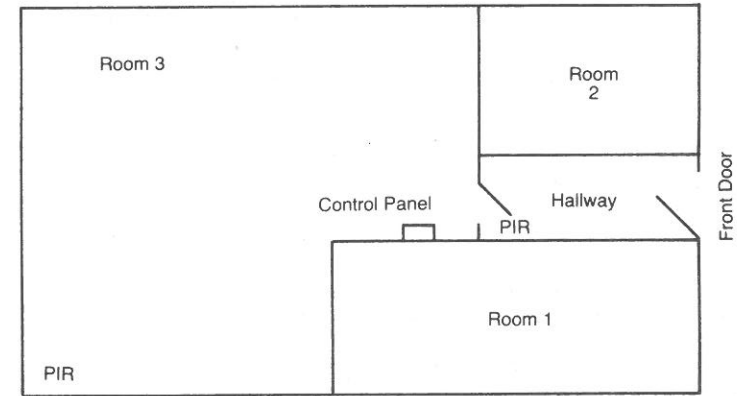

If the walk through facility were not used then once the PIR sensed the movement an alarm would occur before the panel was closed down.

The walk through zone allows a period of time similar to that programmed for the Entry/Exit delay before going into alarm. BUT ONLY IF THE ENTRY/EXIT ZONE IS ACTIVATED FIRST. IF THE ENTRY/EXIT IS NOT FIRST ACTIVATED, AN INSTANT ALARM WILL RESULT. INSTRUCTIONS FOR PROGRAMMING THE WALK THROUGH ZONE ARE DETAILED LATER IN THE INSTRUCTIONS.

## CHIME ZONE

This facility allows the system to monitor the movement of persons around the building whilst the system is disarmed.

As a door is opened, or a PIR senses a movement, then the control panel will give an indication ("chime"). This is useful on external doors, but beware of putting a PIR in a main living area on this function as the constant chiming becomes a nuisance.

## CHANGE USER CODE

It is advisable not to leave the control panel in the factory set code (1234). Instead choose your own personal 4 digit code.

1. Press RESET to clear down the system.
2. Press PROGRAMME FUNCTION and insert the factory code (1234), and the DAY light will begin to flash.
3. Press 1. The four zone lights will now be illuminated.
4. Enter the new house code. As each number is pressed an LED will be extinguished. Once all the 4 numbers have been entered an acceptance beep will be heard and the DAY light will begin to flash.

## SELECTING THE EXIT ZONE(S) (E/E)

All or any zone can be the Entry/Exit zone. (NB. the factory selected E/E zone is zone 1).

1. Ensure DAY light flashing. If not, press RESET, PROG. FUNC. and the engineer code. Factory set (9999).
2. Press 5. The E/E zone currently programmed into the panel will be illuminated.
3. Insert the number of the zone(s) you wish to be E/E. (To remove the E/E zone/s press the zone number and the LED will be extinguished).
4. Press PROG. FUNCTION. An acceptance bleep will be heard, and the DAY light will be flashing.

## SELECTING THE CHIME ZONE

All or any zones can be chime zones. They are entered or removed as follows:-

1. Press RESET, PROG. FUNC. and enter user code.
2. Press 2 and then the appropriate zone number. The zone LED will be illuminated. (To remove a zone, press that zone number and the LED will be extinguished).
3. Press PROG. FUNCTION. An acceptance bleep will be heard, and the DAY LED will be flashing

## SELECTING THE WALK THROUGH ZONE

All or any zones can be designated as walk through zones, with the exception of the Entry/Exit zones.

1. Press RESET, PROG. FUNC. and insert the engineer code. (Factory set (9999)).
2. Press 8. Any preprogrammed walk through zones will show as illuminated LEDs.
3. To make a zone walk through press the requisite zone number. The zone LED will light. To remove the walk through facility, press the zone number, and the LED will extinguish.
4. Press PROG. FUNCTION to store selection.

## CHANGE ENGINEER CODE

Certain facilities are contained under the separate Engineer code. This prevents accidental abuse of the system by inadvertent user programming.

The factory set Engineer code is 9999.

To change the engineer code:-

1. Ensure DAY LED is illuminated.
2. Press PROG. FUNC. All LEDs will illuminate.
3. Insert 9999. The DAY and 24 HOUR lights will flash to indicate you are now in Engineer Programming mode, and the other LEDs extinguish.
4. Press 1. The 4 zone LEDs will now light.
5. Enter your new 4 digit code (it is best not to make it the same as the user code) with the press of each digit a zone LED will extinguish. After the final digit is entered a 2 tone bleep will sound, and the DAY and 24 HOUR LEDs will be flashing.

## SIREN DURATION

To comply with Local Authority Bylaws the unit is set to run for 20 minutes. This can, however, be adjusted as follows:-

1. With the panel in Engineer mode, ie. 24 HOUR and DAY LEDs flashing.
2. Press 4. Two zone LEDs will light.
3. Enter the number of minutes, ie. 01 = 1 minute, 99 = 99 minutes. The 2 LEDs will now be extinguished.

## ENTRY TIME ADJUSTMENT

1. With DAY and 24 HOUR LEDs flashing (Engineer mode).
2. Press 3. Two LEDs will illuminate, the DAY and 24 HOUR LEDs continue flashing.
3. Enter the number of seconds required, ie. 01 - 1 second, 99 = 99 seconds.
4. The 2 LEDs will have extinguished the DAY and 24 HOUR LEDs will still be flashing.

## EXIT TIME ADJUSTMENT

1. With the DAY and 24 HOUR LEDs flashing (eng. mode).
2. Press 2. Two LEDs will illuminate.

3. Enter as No. 3 for exit, time adjustment.
4. The 2 LEDs will have extinguished the DAY and 24 HOUR LEDs will still be flashing.

### PREVENT OMIT OF ZONES

1. Ensure you are in Engineer mode (ie. DAY and 24 HOUR LEDs flashing).
2. Press 6. The DAY and previously programmed zones will flash.
3. Press the number of the zone required to the NON-OMITTABLE.
4. To remove any previously omitted zones, press the requisite zone number and the LED will extinguish.
5. Press PROG. FUNCTION to store selection.

### ENGINEER ONLY RESET

The unit leaves our factory in the user reset mode. It is possible to:-

1. Ensure in Engineering mode.
2. Press 4. Zon 4 LED will illuminate.
3. Press PROG FUNCTION to store.

### SYSTEM RESET

The control can be returned to factory set by one of two means:-

- A Disconnect the battery with the power switched off.
- B Press 0. The unit is now in its factory set mode with the day light on.

To exit the Engineer mode press RESET.

### EXTERNAL SIREN AND BELL BOX

It is desirable to site the unit as high as possible on a building, always remembering to make it as visible as possible. The visual deterrent afforded by the external siren is of utmost importance when protecting a property against intruders.

1. The bell box contains the siren and rechargeable self-actuating siren module (RSCB). The unit is designed to form a weatherproof, self-contained, housing that, if tampered with (by undoing the large retaining screw, or the wires being cut, or the unit pulled from the wall) will sound the siren, and keep it running from its own integral power source (the RSCB).
2. Run a length of 6 core cable from the control panel to the position of the external siren. Drill a hole directly through the wall behind the siren housing so that the

cable enters the rear of the siren housing without showing on the outside of the premises.

3. Remove front cover from back plate by removing the single screw from the bottom of the box.
4. Fix the siren using 3 nuts and bolts onto the backplate as shown. Fig. 10.
- A. Fix microswitch using two nuts and bolts into the position shown. Attach the microswitch with the bent arm to the metal bracket supplied so that the arm protrudes through the circular hole in the backplate, thus giving a back tamper.
- B. The front tamper is made by attaching the microswitch with the straight arm on the reverse of the bracket under the shelf on the backplate so that when the bolt holding the bell box cover in place is screwed in, it engages the arm of the microswitch.
- C. Fix RSCB using 2 nuts and bolts (using the plastic spacers to hold it clear of the backplate).

Fig. 10.

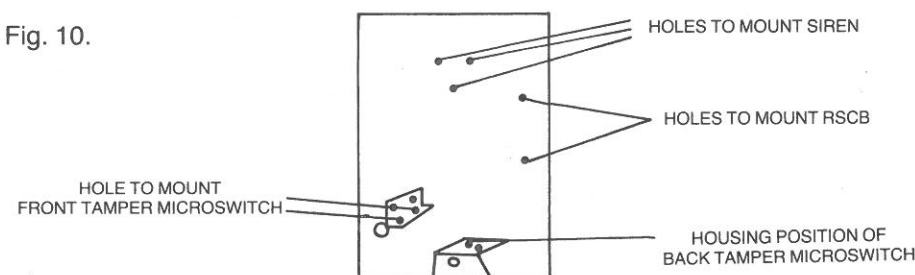

5. Attach the back plate to the outside wall of the building, so that the 6 core cable passes through the large square hole to the rear of the microswitch bracket. Appropriate fixings are to be made via the fixing holes found at each of the 4 corners of the back plate.
6. Connect the 6 core cable as follows:-
  - A. Connect the + (Red) and - (Black) wires to the + (Red) and - (Black) BELL terminals in the panel, and to term. 2 (SW-) and term. 5 (+) on the RSCB.
  - B. Connect the tamper wires (Green & White) to the 24 HOUR terminals in the panel, and to term. 1 (-) and term. 6 (return) on RSCB.
  - C. Connect the siren to the BELL terminals 3 & 4 on the RSCB.
  - D. Connect the strobe (if fitted) to the STR terminals, + Yellow - Blue.

Now that all the external circuits are connected, reconnect the battery, press the RESET button twice to return to the day mode. The yellow LED will now illuminate.



**Pyronix**  
**DELABELL E**  
**DELABELL PLUS**



EN50131-4:2009

**External Sounder Installation Guide**

RINS1270-10

**1) Installation Steps: Step 1**

Slide the PCB module upwards. The sprung back-tamper arm can be retracted to allow removal. This must be done in order to install the revolving guides - see step 4.

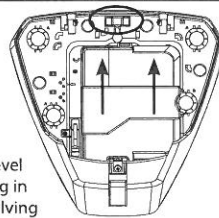

Place the base on a flat surface and ensure it is vertical using the Spirit level that is already installed. Drill and plug in each of the fixing locations. The revolving guides will correct any misalignment. If the Deltabell E/Plus must be mounted on an uneven surface, it is recommended that a tamper levelling screw is used to ensure correct back-tamper operation. See step 2.

**Step 2**

Mounting the Deltabell E/Plus on an uneven surface may cause false triggering, through incorrect operation of the back-tamper.

A POZI number 2 screw driver is recommended for adjusting back tamper screw

The cables to the Deltabell E/Plus should be routed away from the mains supply and telephone cables to avoid any electrical interference.

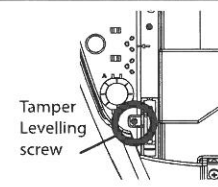

**Step 3**

Insert the guides in as shown. Make sure that the guides 'B' is aligned with the tabs to the right (this is so the PCB module slides in)

Turn each guide until they line up with the drilled holes, while referencing the spirit level for the correct alignment and fix the base firmly to the wall.

Please note, if the Deltabell E/Plus is installed on an uneven surface, it is recommended that you don't tighten up the wall screws until after the module is installed (step 6)

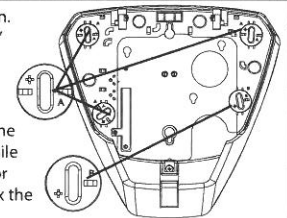

**Step 4**

Place the PCB module, ensuring that the arrow is aligned with the marker (on the left of the module).

Expose the terminals by releasing the latch on the top of the PCB module.

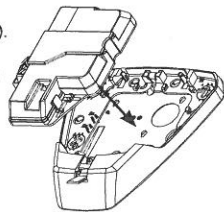

**Step 5**

Route the wires through the guides as shown and then up to the 'teeth' that separates the cables

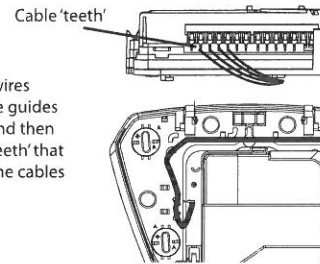

**Step 6**

Fit the lid by sliding its hinges into place. The lid can be supported in the fully open position, to close the lid, apply a little force to push the lid past the holds.

Close the cover, ensure the tamper is operating correctly and insert the 25mm long screw supplied and rotate the screw cover to a close.

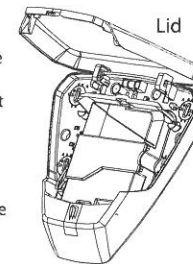

**2) Bell/Strobe Polarity**

The default polarity input triggers are negative applied. To change the polarity please see below:

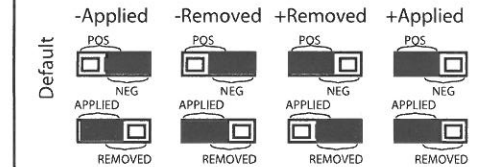

**Deltabell Plus:** Once the strobe is activated, the backlight LEDs will strobe until the activation has stopped.

**Deltabell E:** Once the strobe is activated, the LEDs at the bottom of the PCB will strobe until the activation has stopped.

**3) Backlight**

The Deltabell Plus now incorporates an LDR feature where the backlight is only enabled at night time.

The backlight can be disabled as shown below



**4) Battery Connection**

The battery will already be connected, to enable, the 'BAT DISCONNECT' link must be placed. An external battery may also be connected and the 'BAT+' terminal space may be used for this.

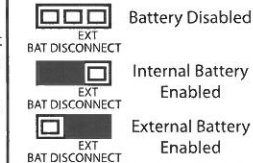

**5) LED Enable/Disable and SAB/SCB Mode**

There is the option to enable/disable the comfort LEDs by enabling/disabling the 'LED DISABLE' link:

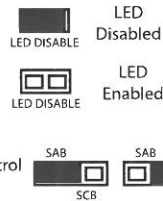

**SAB Mode**  
Uses power from the control panel 12V output

**SCB Mode**  
Uses power from backup battery

(Useful for when there are 2 x Deltabells on the same system)

**6) External Engineer Hold Off**

The Deltabell E/Plus has an external engineer hold off function. When first powered with the tamper switch open, the sounder will not activate. To enable the sounder for specified operation, the tamper switch must be closed

The Engineer Hold Off terminal is used to disable the cover tamper switch when a control panel is in Engineer Mode. Applying 0V to the 'ENG HOLD' terminal over-rides the tamper circuit allowing access to the Deltabell E/Plus without sounding the alarm.

**7) Self Activating Engineer Hold Off**

The Deltabell E/Plus also has a self activating engineer hold off function. If the sounder is only powered by the battery (before any auxiliary inputs are connected), the siren will not activate until the auxiliary inputs are connected.

The comfort LEDs on the Deltabell E/Plus will flash alternatively three times which confirms to the engineer that the tampers are closed correctly.

Once the auxiliary inputs are connected the Deltabell E/Plus will be fully operable.

**8) Deltabell to Control Panel Connection**

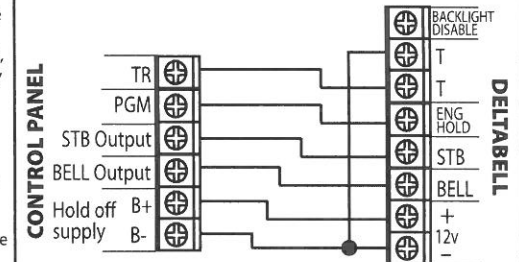

**9) Technical Specification**

Supply Voltage	9-16VDC
Quiescent Current	Deltabell E < 30mA, Deltabell Plus < 60mA
Alarm Current	Deltabell E < 250mA, Deltabell Plus < 300mA
Strobe Duration	10mS
Strobe Frequency	1Hz
Sound Pressure Level	104dB(A)
Dimensions	290 x 285 x 50mm
Reverse Polarity Protected	

**10) Warranty and Compliance**

This product is sold subject to our standard warranty against defects in workmanship for a period of two years. Please note: In positions where the Deltabell E/Plus casing is subjected to high levels of U.V. sunlight, there may be risk of case colour fading, this is not covered by the warranty. In the interest of continuing improvement of quality, customer care and design, Pyronix Ltd reserve the right to amend specifications without giving prior notice.

For electrical products sold within the European Community. At the end of the electrical products useful life, it should not be disposed of with household waste. Please recycle where facilities exist. Check with your Local Authority or retailer for recycling advice in your country.



When disposing of the product, the batteries must be removed and disposed of separately in accordance with the local regulations.

**Suitable for use in systems installed to PD6662:2010 at Security Grade 2, Environmental Class 4.**

**11) Connections to other control panels**

Deltabell E/Plus	+	-	BELL	STB	TAMPER
<b>Sterling 10</b>	Bell+	Bell-	Bell NO	STB NO	BT Bell-
<b>Matrix</b>	Aux+	Aux-	PGM1(No)	PGM2(No)	BT B-
<b>PCK/Euro 1</b>	Aux+/B+	Aux-/B-	PGM1/BELL	PGM2/STB	TR Aux-/B-
<b>ADE</b>	D	A	B	STROBE-	T A
<b>Scantronic</b>	12V	0V	BELL	STROBE-	TR 0V
<b>Texcom</b>	A	D	B	S	C D
<b>Menvier</b>	Bell +12V	HOLD OFF	BELL TRIG	STB	TAMP RTN HOLD OFF
<b>GE</b>	BELL +12V	BHO	EXT BELL-	STROBE-	270R TR HO
<b>Risco/Gardtec</b>	BELL+	SCBA	BELL	-STB	SCBP SCBA
<b>DSC Range</b>	BELL+	AUX-	BELL-	PSM1	ZONE
<b>HKC</b>	EXT BELL+	SAB HOLD	EXT BELL-	PGM Output 4	TAMPER RTN SAB HOLD (with 4k7)

Negative Tamper Return: Link between TAMPER and B-  
Positive Tamper Return: Link between TAMPER and B+

**12) Contact Information**

Technical Support Line: 0845 6434 999 (local rate) or call +44(0)1709 535225

Hours: 8.00am - 6.30pm, Monday to Friday

customer.support@pyronix.com  
marketing@pyronix.com

www.pyronix.com

Pyronix Ltd, Braithwell Way, Hellaby, Rotherham, S66 8QY, UK

# Deltabell E / Plus

Grade 2 Self Powered External Warning Device



Security Grade (SG) 2  
Environmental Class (EC) IV  
EN50131-4:2009  
PD6662:2010

## ENGLISH (references A-E):

**A TAMPER LEVELLING SCREW:** Adjust the screw accordingly to make sure the tamper operates as specified on surface that the Deltabell is installed upon.  
**B REPLACING THE BATTERY:** The Deltabell battery is located within the Deltabell module. The replacement battery must be a NiMH 7.2V, 250mAh.

**C ENGINEER HOLD OFF:** When the Deltabell is initially powered with the tamper open, the siren will not activate. To enable the siren for specified operation, the tamper must be closed. This terminal can be connected to a PGM programmed as 'Engineer Access' (0v applied) so that the tamper on the Deltabell is disabled when in the Engineer Menu on the control panel.  
**D** The Deltabell Plus now incorporates an LDR feature which allows the backlight to illuminate automatically at night time. The backlight can also be disabled as shown (Deltabell Plus only)  
**NOTE: Please be aware of light pollution and seasonal daylight changes that may affect LDR timing (e.g. staying lit for longer during dark winter months).**

**E BELL STROBE POLARITY:**  
The default polarity input triggers are negative applied. To change the polarity see the diagram table.  
**Deltabell Plus:** Once the strobe is activated, the backlight LEDs will strobe until the activation has stopped.  
**Deltabell E:** Once the strobe is activated, the LEDs at the bottom of the PCB will strobe until the activation has stopped.

**NOTE:** The Deltabell (warning device) must be powered via the control panel with a current limited to 0.5A from a generally limited power source. It must also be powered by a SELV circuit ONLY and should be installed by qualified personnel.  
**IMPORTANT:** Please ensure that the wall plug that you are using is compatible with the surface that you are fixing this external siren to (a general purpose brown plastic wall plug should be suitable for most cases).

## Self Activating Engineer Hold Off

If the Deltabell is only powered by the battery, the siren will not activate until the auxiliary inputs are connected. The comfort LEDs will flash alternately three times which confirms that the tampers are closed correctly. Once the auxiliary inputs are connected the Deltabell will be fully operable.

## Specification

Supply Voltage range: 11.8-16V d.c. (Nominal: 13.8V d.c.)  
Quiescent Current: 30mA (Deltabell E) 73mA (Deltabell Plus)  
Alarm Current: 250mA (Deltabell E) 300mA (Deltabell Plus)

Strobe Duration & Frequency: 10mS, 1Hz  
Sound Pressure Level: 104dB(A) Acoustic Output: Tone  
Maximum Sound duration: 15 mins Battery Type: NiMH 7.2V, 250mAh  
Temperature: (certified); -25 to 60°C (nominal); -30 to 60°C (at 95% humidity)  
Dimensions (base): 290x285x50mm. Lid: 219(H)x276mm(V) Weight: 0.971kg.  
Ingress Protection: IP34  
Remotely powered. Upon loss of remote power, the siren will operate. Reverse polarity protected. For wall mounting only.

## Product Information

For electrical products sold within the European Community. At the end of the electrical products life, it should not be disposed of with household waste. Please recycle where facilities exist. Check with your Local Authority or retailer for recycling advice in your country.

When disposing of the product, the battery must be removed and disposed of separately in accordance with the local regulations. To prevent possible damage to components, any static charge on your body needs to be eliminated before touching the inside of the unit. This can be accomplished by touching some grounded/earthed metallic conductor such as a radiator/pipework immediately before replacing the batteries.

## Warranty

This product is sold subject to our standard warranty conditions and is warranted against defects in workmanship for a period of two years. Please note: In positions where the Deltabell casing is subjected to high levels of U.V. sunlight, there may be risk of case colour fading, this is not covered by the warranty. For further information please visit: [www.pyronix.com/warranty](http://www.pyronix.com/warranty)

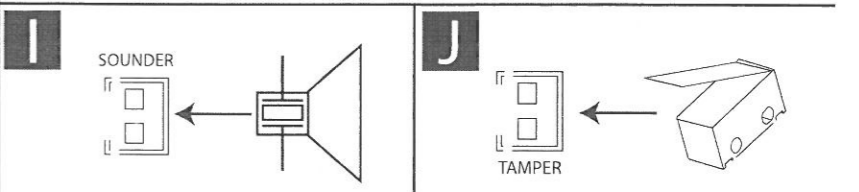
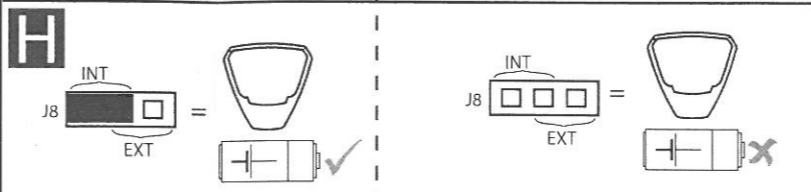
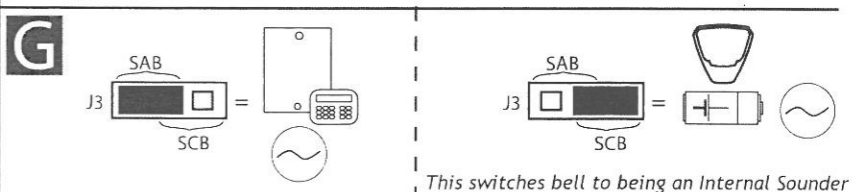
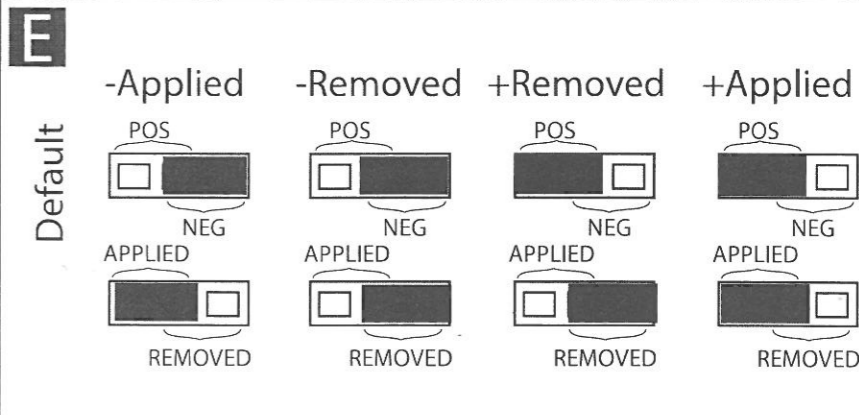
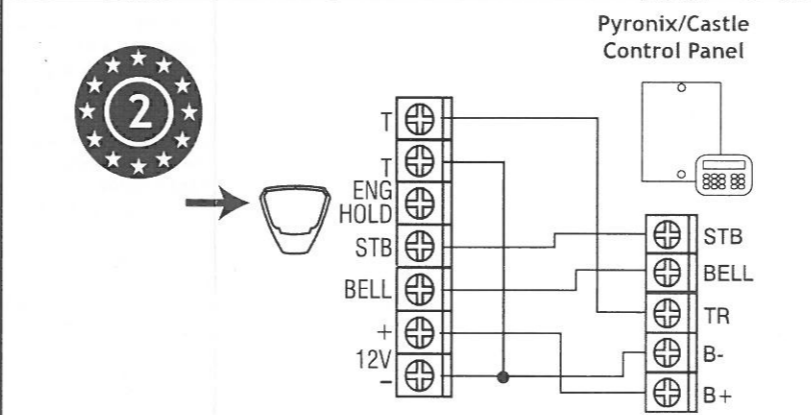
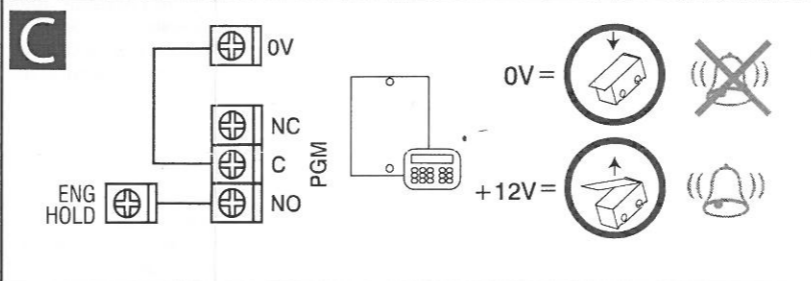
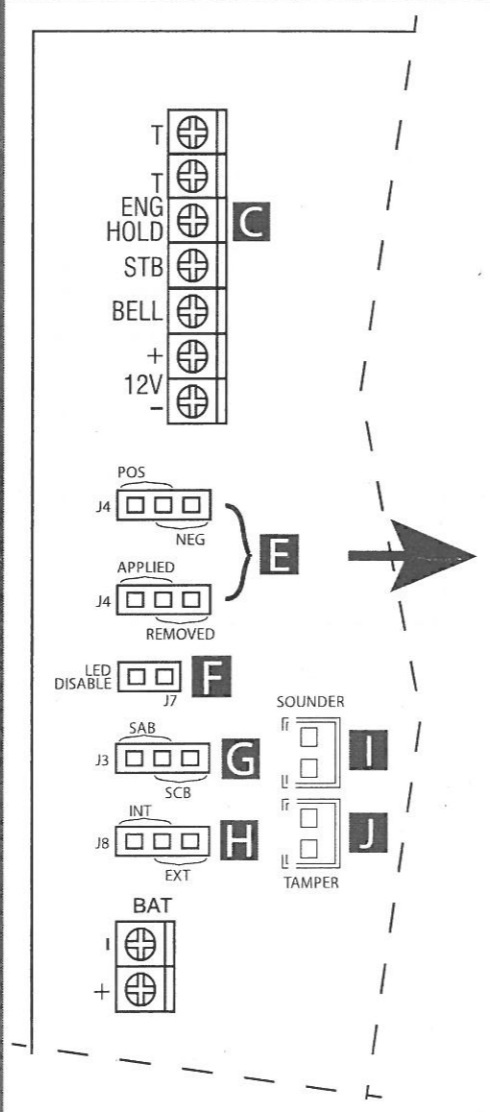
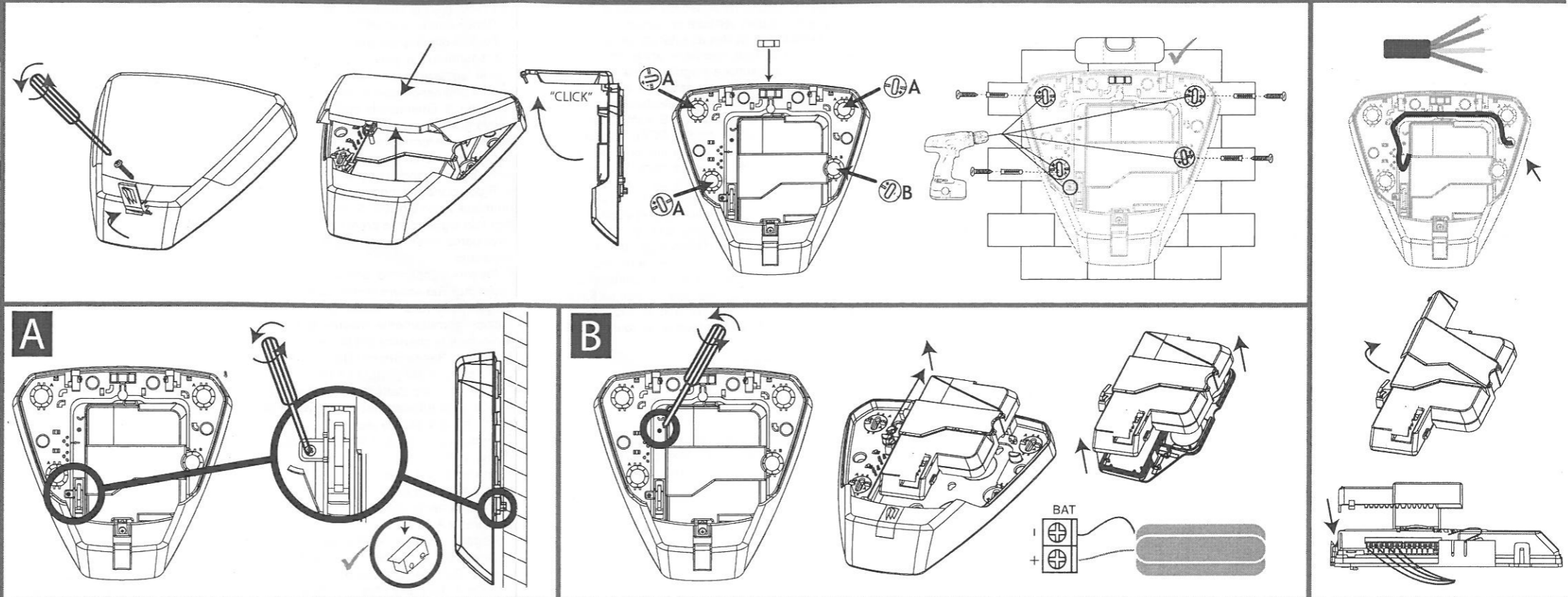

This switches bell to being an Internal Sounder