

BM/1420 & BM/1426 Dimensions

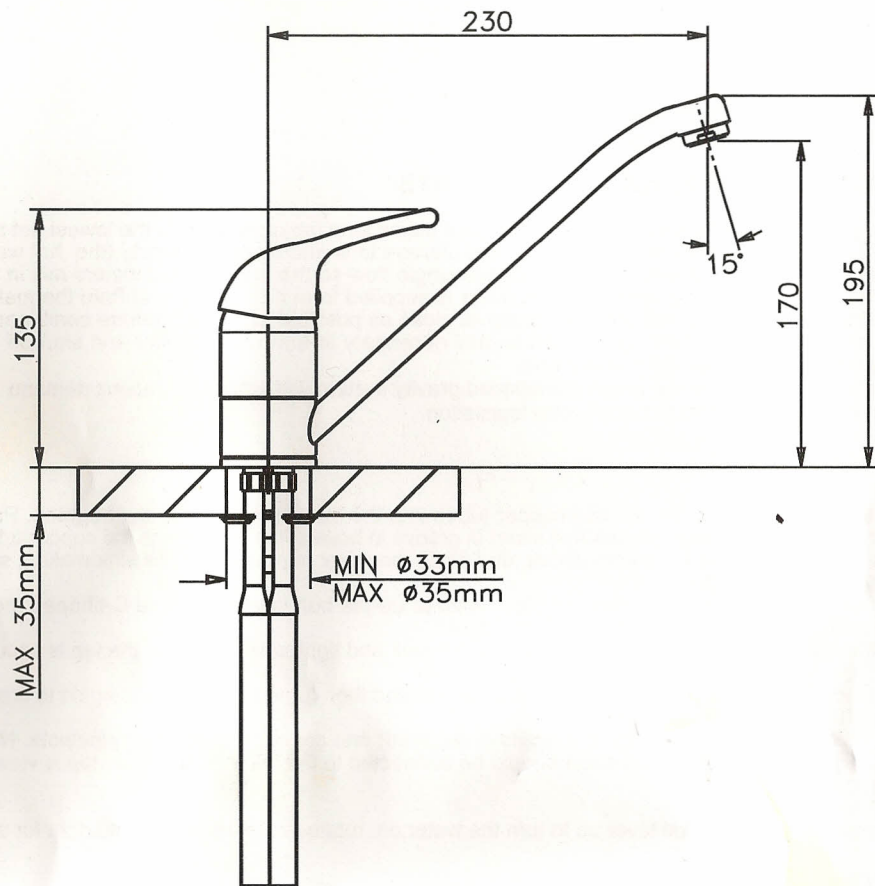

GUARANTEE & LIABILITY

In the unlikely event that you should experience any defect in the material or workmanship of your tap within 2 years of purchase, we will replace the faulty part free of charge. Decorative surface finishes are guaranteed for one year from the date of purchase provided that our advice concerning care and maintenance has been observed. This is also provided that the tap has been used for normal domestic purposes in the UK and that the installation instructions have been observed. Scuffs and scratches caused by normal wear and tear, improper installation or accidental damage are excluded from this guarantee. You should retain a copy of your dated invoice as proof of purchase to validate any claims under this guarantee. No other warranties, express or implied, are made.

**For technical advice, after sales service and spare parts
for Blanco brassware please ring
01709 819077**

BLANCO

BLANCOSWIFT BM/1420 BLANCOSWIFT BM/1426*

*Water saving 6 Litre/min. variant

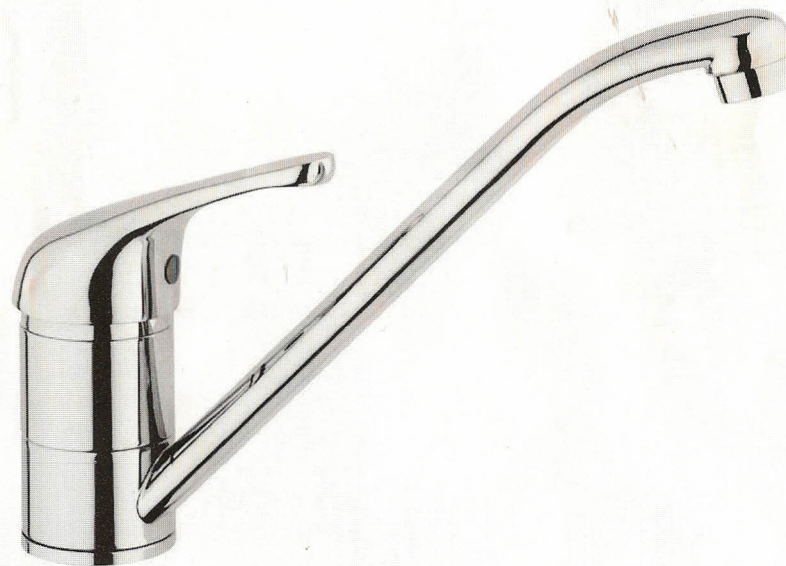

INSTALLATION AFTERCARE

Please leave with the end user.
The information in this publication identifies the product and parts and also provides valuable after care information.

BM/1420 & BM/1426 Parts List

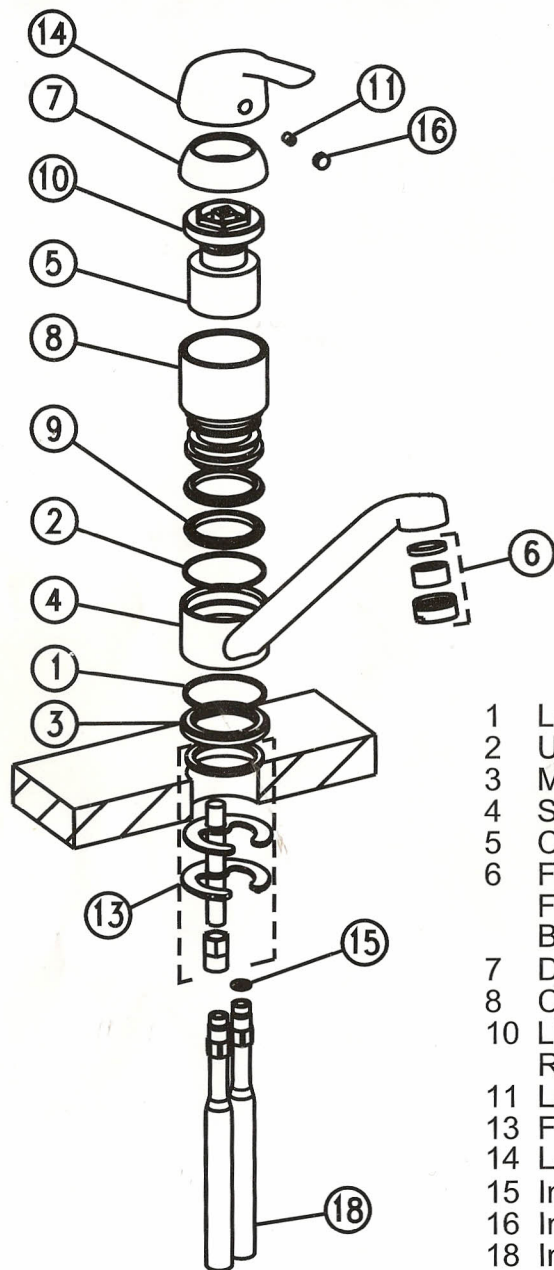

- 1 Lower P.T.F.E. ring
- 2 Upper P.T.F.E. ring
- 3 Metal ring base
- 4 Spout
- 5 Cartridge
- 6 Flow straightener BM/1420
Flow restrictor 6L/min
BM/1426
- 7 Dome cap
- 8 Cartridge containment body
- 9 Retaining ring
- 10 Lip seal
- 11 Lever screw
- 12 Lever
- 13 Fixing kit
- 14 Lever
- 15 Inlet pipes O-ring seal
- 16 Indices
- 17 Inlet copper pipes

SITE REQUIREMENTS

Min. head	3 m
Min. pressure	0.3 bar
Taphole size	35 mm
Max pressure	5.0 bar
Rec. max temp	55°C
Connection	BM/1420 Part 19 Flexi tails BM/1426 Part 18 15mm copper tails

PREPARATION AND BYELAW REQUIREMENTS

First shut off your water heating system then, with your mains stop tap closed, open the lowest hot and cold taps in the house and allow to run until the cold storage tank and pipes are empty (the hot water storage cylinder always remains full). These taps are single flow so the hot and cold waters mix in the body. Water byelaws require that where the hot water is supplied from a tank and cold from the mains, check valves are fitted on both hot and cold pipes as close as possible to the tap. Where combination boilers or high pressure cylinders are fitted it is only necessary to turn off the boiler and shut off the incoming mains - check valves are not required.

*Note: When fitting this type of tap on an unbalanced gravity system, UK water regulations demand that non return valves are fitted to comply with legislation.

INSTALLATION

First screw the fixing bolt and the two copper tubes into the mixer body. Do not over-tighten. Pass the rubber washer over the copper tubes and insert in groove in base of tap body. Pass the copper tubes and fixing stud through the sink top from above, and place the mixer in position on the sink making sure the O-ring is in place to make a seal.

Working under the sink, slide the C-shaped black washer up the bolt followed by the C-shaped metal washer and secure with the brass fixing nut finger tight.

Check that the mixer body is correctly positioned on the sink and tighten fixing nut so the tap is secure. Do not overtighten as damage may be caused to the sink.

At this stage the tails may have to be gently bent outwards and then turned to face down again to create enough space to make the connections.

Screw the check valves onto the ends of the tails (if required) and connect to incoming pipework. Note arrow indicating direction of flow. Hot water should be connected to the left inlet when the tap is viewed from the front.

The tap is operated by pulling the lever up to turn the water on, rotate left for hot water and right for cold

ATTENTION

Before installing the mixer it is essential that you thoroughly flush through the supply pipes in order to remove any remaining swarf, solder or other impurities. This should be repeated with the aerator nozzle removed after installation to clear any debris from the tap.

Failure to carry out this simple procedure will possibly cause problems or damage to the workings of the mixer resulting in leaking within a short period of time after installation.

Having first checked all new connections, turn on the mains stop cock, close all taps except the new mixer and as the system starts to refill check for leaks.

Once you have satisfied yourself that there are no leaks, switch on the water heating.

WARNING

These hints have been prepared for your guidance, you must exercise due care all the times. We do not accept responsibility for any problems that may occur through incorrect installation. We recommend that in all instances a qualified professional installer is used to fit and commission the tap.

HOW TO CARE FOR YOUR KITCHEN SINK MIXER

To maintain the appearance of this fitting, ensure it is cleaned only using a clean, soft damp cloth. A solution of warm water and mild liquid detergent may be used where necessary, and then the fitting rinsed thoroughly. Do not use spray cleaners or abrasive material ie wire wool or scotch bright pads. Avoid cleaners containing bleach and limescale removers.