

These assembly diagrams are intended as a guide – if in doubt consult a qualified electrician.

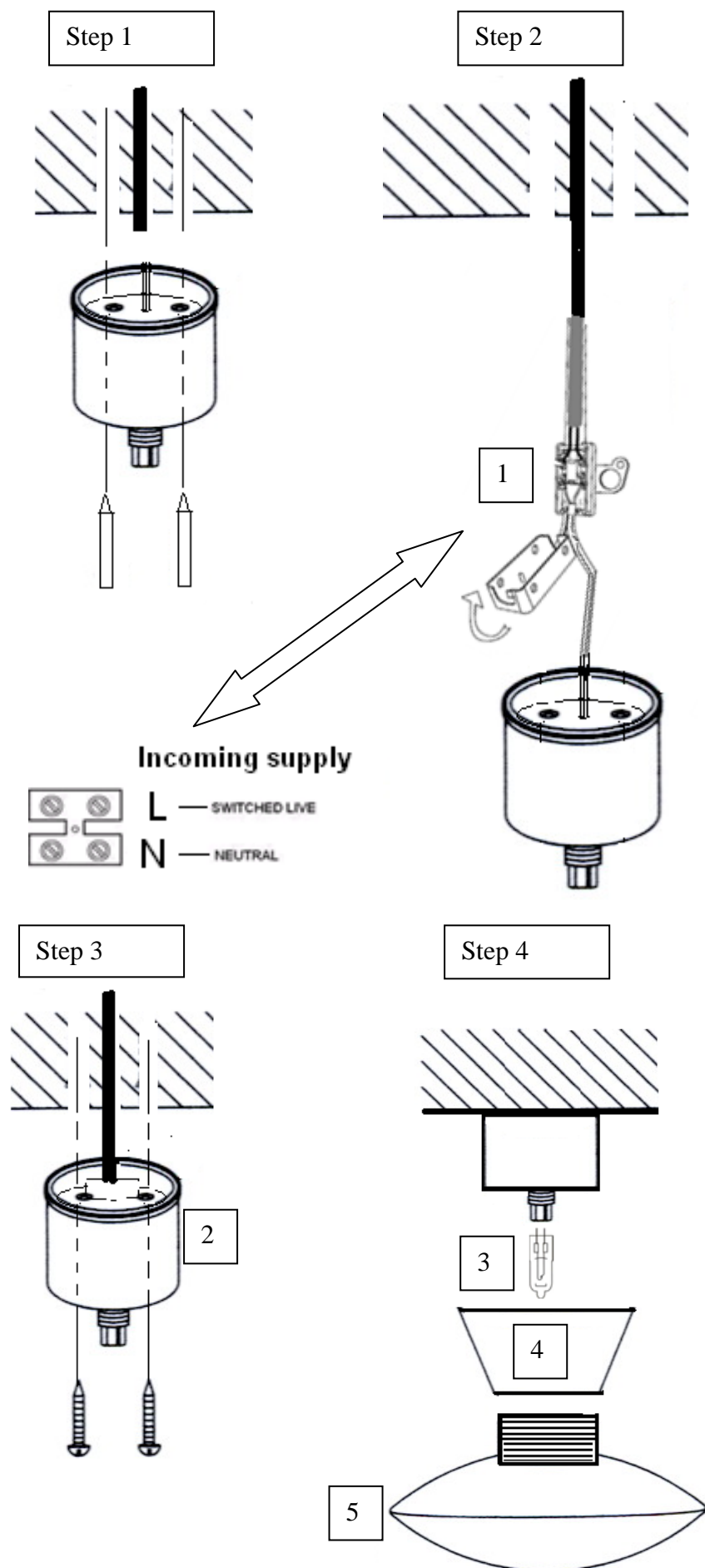

- Step 1.** Decide on the position of the light fitting / or remove existing light fitting. Take a note of the electrical connections. Ensure there is a solid mounting surface, preferably a wooden joist or joist bridge to support the weight of the light fitting.
- Carefully mark and prepare the 2 mounting holes.
- Step 2.** Support your fitting and connect the house wiring to the terminal block (1). – see also details of terminal wiring. **NOTE: This is a Class II fitting and must not be earthed. If you have any earth cables make sure that they are connected to each other – to maintain earth continuity throughout your property – and wrap the earth terminal and connections in 2 layers of good quality insulation tape and keep them away from the terminal connections of the fitting.** Open the terminal block box and take out the long tailed grommet, sliding it up the house supply cable. Cut and strip the cable and connect it to the terminal block as shown. Re-fit the long tailed grommet. Close the box. The 'spare' terminal block connector can be used for the "loop" wires of the "Ring Circuit". There may be more than one set of cables in the "loop" connections. This terminal should be outside the fitting and wrapped in 2 layers of good quality insulation tape. If there is a "Ring Circuit" and you do not understand the connections you must consult an electrician.
- Step 3.** Fix the back plate (2) to the ceiling, taking care not to trap or strain any cables.
- Step 4.** Fit the bulb (3). **NOTE: Never fit bulbs of a higher wattage than that specified on the label (as this may cause overheating and damage the fitting).** Place your chosen base (4) (white / chrome) over the lamp holder assembly and then carefully fit the diffuser (5). **NOTE: Make sure that all seals are correctly located to ensure that the water ingress protection of the fitting is maintained.**
- Turn on the power and switch on to test.